



## COR VISION SYSTEM

CORTIZO has designed more than 50 exclusive systems of windows, façades, composite panel and solar protection systems. This commitment to innovation allows us to offer high value added products, maximizing energy efficiency, thermal and acoustic insulation and resistance to atmospheric agents.

INNOVATION

TECHNOLOGY

QUALITY

EFFICIENCY

GUARANTEE

SUSTAINABILITY

AESTHETIC

FUNCTIONALITY

DESIGN

COMFORT

R+D+I

# COR VISION SYSTEM



Sliding system with Thermal Break of avant-garde design seeking maximum brightness with the minimum amount of seen aluminum profile centre junction section in the market, only 2cm. and allows enclosing large openings of up to 13.2 (width) x 3 (height) metres in 6 sashes.

An elegance in design with the possibility of meetings at a 90° corner without mullions, achieving clear open spaces to enjoy the outside view.

- Valores máximos en eficiencia energética: transmitancia de ventana desde 1,3 (W/m²K)\*.
- Máxima protección frente al ruido: hasta 41 dB de reducción acústica.

#### CATEGORÍAS ALCANZADAS EN BANCO DE ENSAYOS\*

Permeabilidad al aire	CLASE 4 (máxima)
Estanqueidad al agua	CLASE 7A
Resistencia al viento	CLASE C5 (máxima)

#### POSIBILIDADES DE APERTURA

Corredera de 2, 3, 4 y 6 hojas.  
Posibilidad tricarril.  
Monocarril (1 hoja+1 fijo).  
En esquina a 90° sin parteluz.  
Galandage de 1 y 2 hojas.

\*CONSULT TYPOLGY, DIMENSION AND GLASS.



## RESISTANCE TO ATMOSPHERIC AGENTS [CORTIZO COMFORT]

All of CORTIZO's enclosing systems are tested in the Test Laboratory at the Technological Center to guarantee the best performance in watertightness, air permeability and wind loads, endorsed by the maximum results in its test qualifications.

## THERMAL INSULATION [CORTIZO ENERGY EFFICIENCY]

Nowadays energy efficiency in buildings is a demand made, both by the architects, as by the final customer aware of the importance of saving on heating costs and air conditioner. CORTIZO meets such challenge with systems for every climatic area with a high insulation coefficient to ensure the comfort in the residence.

## ACOUSTIC INSULATION [CORTIZO SILENCE]

In order to transform the residence into a private space, intimate and free of pollution outdoor acoustics, CORTIZO has designed its enclosing systems with all the latest technological developments necessary to ensure indoors peace and relax.

## UNLIMITED COLOUR RANGE [CORTIZO COLOURS]

The whole RAL colour chart in powder coating, exclusive powder coating, metallic, textured, wood effect, more than 100 finishes in anodized. Aluminum on the outside and wood in the inside, two-coloured finishes... An unlimited offer to create a colour harmony at home. Quality labels in every process: QUALICOAT, SEA-SIDE, QUALIDECO and QUALANOD.

## AVANT-GARDE AESTHETICS [CORTIZO DESIGN]

We create tailor-made windows and façades for every project. Creativity to answer aesthetically and functionally to each demand. Aesthetic answers to the technical needs. Creativity at the service of habitable environments.

## ENCLOSURES FOR LIFE [CORTIZO DURABILITY]

Aluminum is the most durable, long-standing and resistant material of those used in enclosures. Aluminum has the strength and a durability of the things that last a whole lifetime.

## SUSTAINABLE SPIRIT [CORTIZO SUSTAINABILITY]

Respect for the environment is CORTIZO'S commitment. Using innocuous raw materials and products in all our manufacturing process and the limitless possibility of aluminum recycling, allows us to remove any creation of waste and environmental risks.



FOR MORE  
INFORMATION  
CONSULT  
OUR WEB

[www.cortizo.com](http://www.cortizo.com)

## Cor-Vision Sliding System with thermal break

An avant-garde design of a thermally broken sliding system that permits maximum luminosity with the minimum amount of seen aluminium profile section. An elegance in design that looks to cover great light spaces with minimum frame fragments of between 9-14% of the total surface. It shows seen centre junction sections of only 20 mm, in the lateral junction at 77 mm and the top/bottom junctions at 57 mm.

Possibility of inlaying the bottom, top and lateral frames.

Possibility of sash meetings at a 90° corner without a mullion.

In its monochannel version, comprising of fixed and sash, the hidden rail is found in the fixed area.

It incorporates the new type of **GALANDAGE** that is designed to allow the possibility of an integral opening in the space to completely conceal the sashes in the building curtain wall chamber. In this way a 100% opening surface can be achieved.

This **GALANDAGE** option is made up of a single and dual channel rail which allows for a single or double sash concealed balcony doors.

This presents a new type of frame for 1, 2 or 3 rails that allows the incorporation of a stainless steel rail that affords increased sliding smoothness, an increase in loading support for the bearings (up to 320 kg/sash) and increased durability.

A system with traditional fitting procedures with perimetral frame and sashes that allows the sash to be dismantled in case of glass breakage, damage to the aluminium profile etc. It incorporates a rod operated multipoint lock.



# Cor-Vision Sliding System with thermal break

## Transmittance

Uw from 1,3 (W/m²K)

Please consult typology, dimensions and glass

## Acoustic insulation

Maximum glazing: 30 mm.

Maximum acoustic insulation **Rw=41 dBA**

## Finishes

Possibility of dual colour

Colour powder coating (RAL, mottled and rough)

Wood effect powder coating

Anti-bacterial powder coating

Anodized

## Categories achieved at test centre

Air permeability  
(EN 12207:2000): Class 4

Water tightness  
(EN 12208:2000): Class 7A

Wind resistance  
(EN 12210:2000): Class C5  
Reference test 1,23 x 1,55 m. 1 sash + 1 fixed light



## Sections

Frame 116 mm.

182 mm. 3 rails

Sash 37 mm.

## Profile thickness

Door 1,7 mm.

Polyamide strip length from 16 mm. to 24 mm.

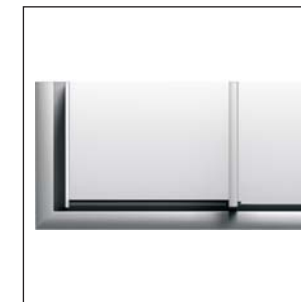
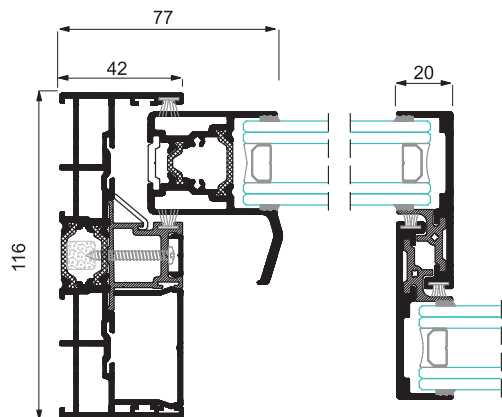

## Opening possibilities

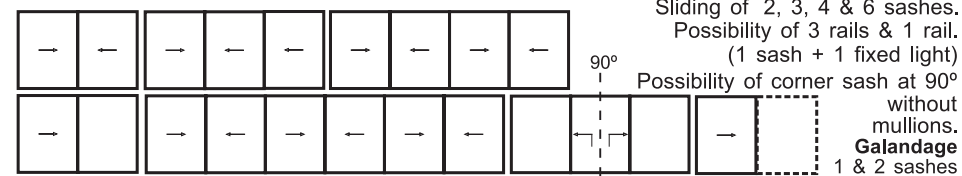

## Maximum dimensions

Width (L) = 4.400 mm.  
Height (H) = 3.000 mm.  
2 sashes door

## Maximum weight/sash

320 Kg.

Please consult regarding maximum weight and dimensions for other opening types



Sistema / System

# › COR VISION

SISTEMAS DE ALUMINIO Y PVC PARA LA ARQUITECTURA  
ARCHITECTURAL ALUMINIUM AND PVC SYSTEMS

Sistema / System  
COR VISION



CERRAMIENTOS CONTEMPORÁNEOS  
CONTEMPORARY ENCLOSURES





Muestra ensayada por / Sample tested by  
ALUMINIOS CORTIZO S.A.U.



### Transmitancia / Transmittance

**$U_w \geq 1,3$  (W/m<sup>2</sup>K)**

Consultar tipología, dimensión y vidrio.  
Consult typology, dimensions and glass.

### CTE - Apto para zonas climáticas\*: $\alpha$ A B C D E

\*En función de la transmitancia del vidrio.

### Aislamiento acústico / Accoustic insulation

Máximo acristalamiento  
Maximum glazing **30 mm**

Máximo aislamiento acústico  
Maximum accoustic insulation **R<sub>w</sub> = 41 dB**

### Secciones Sections

### Espesor perfilera Profile thickness

Marco / Frame	116 mm	Puerta / Door	1,7 mm
	182 mm tricarril		
Hoja / Sash	37 mm		

Longitud varilla poliamida  
Polyamide strip length **16 - 24 mm**

### Categorías alcanzadas en banco de ensayos Categories achieved at test centre

Permeabilidad al aire / Air permeability  
**(UNE-EN 12207:2000): Clase / Class 4**

Estanqueidad al agua / Water tightness  
**(UNE-EN 12208:2000): Clase / Class 7A**

Resistencia al viento / Wind resistance  
**(UNE-EN 12210:2000): Clase / Class C5**

Ensayo de referencia ventana 1,23 x 1,48 m, 1 hoja + 1 fijo.  
Reference test 1,23 x 1,48 m, 1 sash + 1 fixed light.

### Acabados / Finishes

Posibilidad bicolor / Possibility of dual colour  
Lacado colores (RAL, moteados y rugosos) / Colour powder coating (RAL, mottled & rough)  
Lacado imitación madera / Wood effect powder coating  
Lacado antibacteriano / Anti-bacterial powder coating  
Anodizado / Anodized

### Posibilidades de apertura Opening possibilities

Corredera de 1, 2, 3, 4 y 6 hojas  
Posibilidad monocarril, bicarril y tricarril  
Posibilidad de apertura en esquina y rincón a 90° sin parteluz  
Posibilidad galandage de 1, 2, 3 y 4 hojas

Sliding of 1, 2, 3, 4 & 6 sashes  
Possibility of 1, 2 or 3 rails  
Possibility of interior and exterior corner sash at 90° without mullion  
Galandage possibility in 1, 2, 3 & 4 sashes.

### Dimensiones máximas/hoja Maximum dimensions/sash

Ancho / Width (L) = 2500 mm  
Alto / Height (H) = 3000 mm

Consultar peso y dimensiones máximas según tipología.  
Consult maximum weight and dimensions in accordance to typology.

**Peso máximo/hoja**  
**Maximum weight/sash** 320 Kg

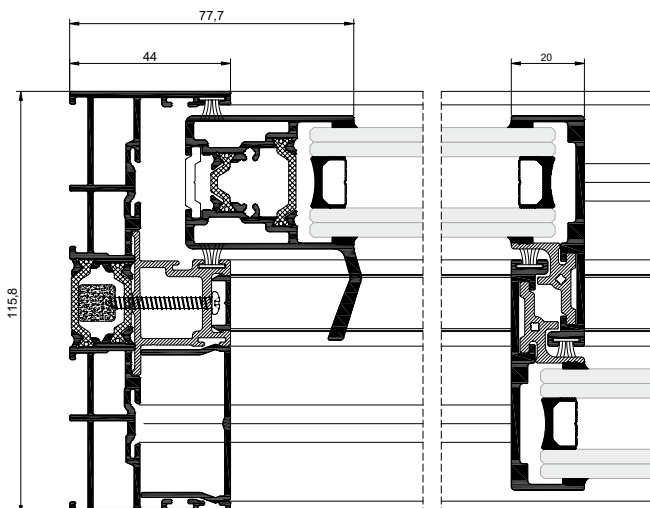

**Diego Piñeiro Janeiro**  
Director de I+D+i / R&D Manager



